

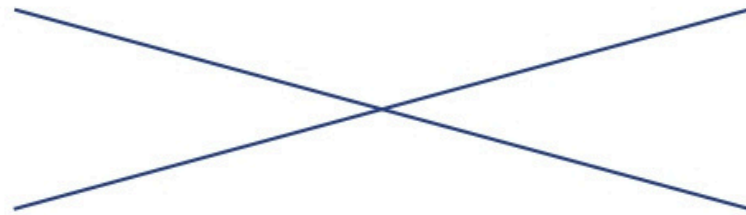

TURECIDI

Project X370

TUREGDI





ArDeMo YACHT & DESIGN

ArDeMo Yacht&Design is a division of ArDeMo Firenze coordinated by the co-founder Leonardo Cecchi, a florentine yacht designer.

ArDeMo is a multidisciplinary office made by 3 different independent macro areas, Architecture / Design / Modelling, which are operating in 3 different design fields from 2018, in order to give to every customer a complete support thanks to the 3 co-founders' various working experiences and the interaction between the different professional skills of employees inside and outside the group.

Thanks to the experience gained in yacht design, started in 2010 and including production assistance, interior/exterior technical design and concept design for several Italian shipyards, the team takes care of the complete design development of sailing and motor yacht driven by the spirit of technical research and innovation helped by the knowledge of the latest software 2D and 3D dedicated to design.

ArDeMo YD is totally committed in the realization of yacht& interior design projects with the aim of transforming the dreams of the customer and his emotions in innovative reality that can last a long time.



TUREGDI

Drawing from the solid experience gained over the years in supplying components that enabled the first generation to craft finished boats for third parties, ranging from Superyachts to racing motorboats, and including the refit of historic sailing boats like the S/Y Invader, the group decided to establish its own business. In collaboration with renowned architects, they set out to create their signature products.

Our shipyard represents a unique fusion of British corporate governance and Italian craftsmanship. Based in the UK, our company adheres to the stringent standards, legal frameworks, and procedural rigor characteristic of British corporate entities.

Despite our UK domicile, the soul of our yachts is quintessentially Italian. We proudly produce our vessels in Italy, leveraging the country's storied tradition of yacht construction and its reputation as a world hub of yachting. Our yachts are crafted in the renowned shipbuilding areas of Viareggio and Pisa, where the Italian flair for design and luxury is evident in every curve and contour.

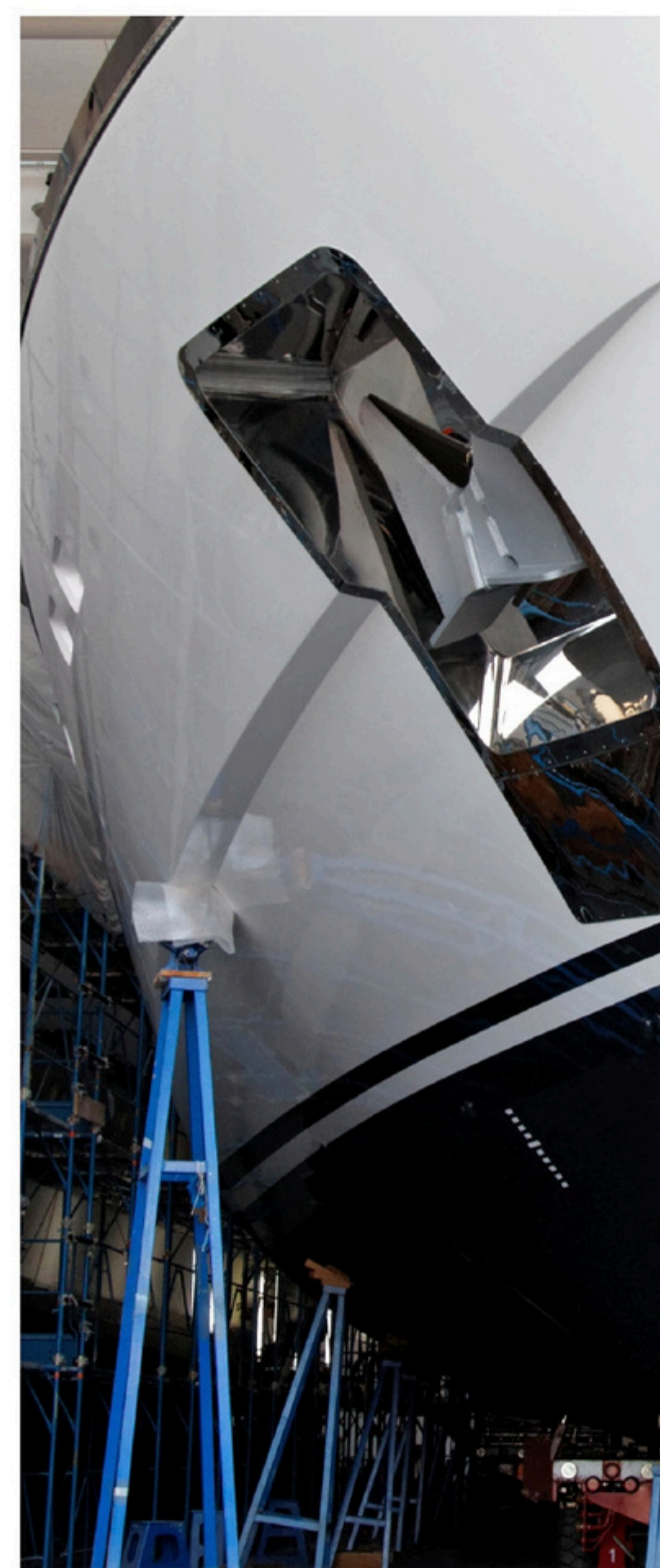

By marrying the Italian passion for aesthetics and attention to detail with the British ethos of corporate excellence, we create yachts that are not only visually stunning but also built to the highest standards of quality and performance.

The 'Made in Italy' label is a testament to the unparalleled craftsmanship and innovative spirit that goes into each of our yachts, ensuring that they resonate with the luxury and sophistication that clients expect from Italian-built vessels.

Tureddi is upholding the highest standards of both British business practices and Italian yacht-building heritage.

We welcome you to consult us for the development of your superyacht custom projects.

TUREDDI

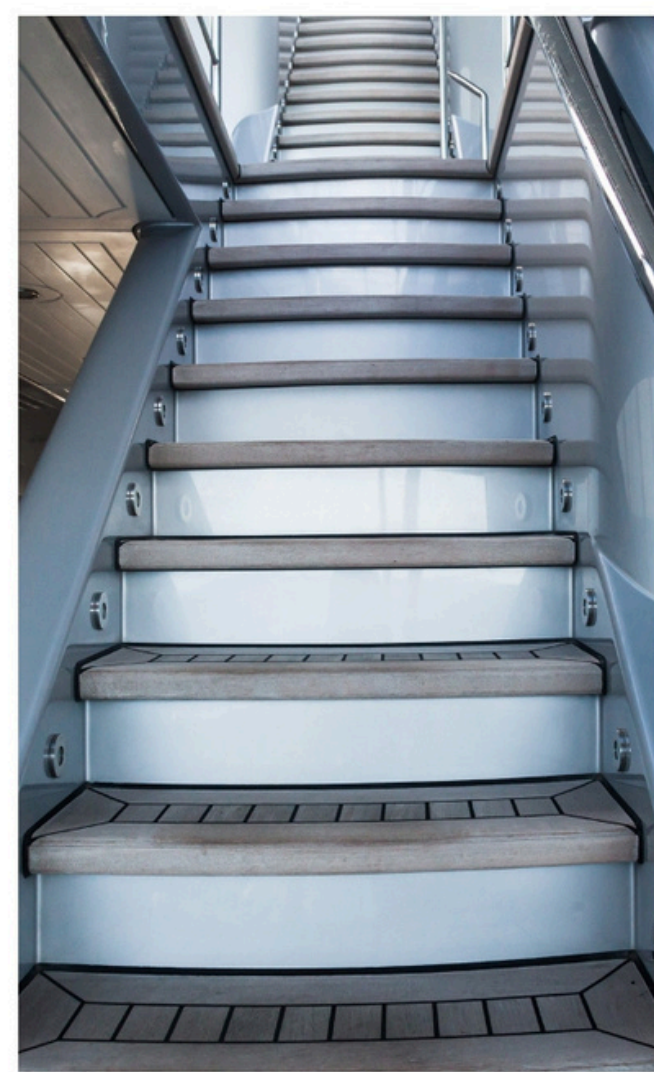



PROJECT X370

Motor yacht

Exterior : Leonardo Cecchi

Interior : Leonardo Cecchi

Length : 37 m

Width, maximum (over-all) : 10.3 m

Beam : 8.8 m

Draft : 2.3 m

Displacement : Full displacement 325MT

Gross Tonnage: 244 GT

Engine: 2x CAT 32 1500hp

Max Speed: 16 knots

Cruise Speed: 13 Knots

Guests	Crew	Cabins	Crew Cab.	Decks
10	4 + 1	4 + 1	2 + 1	4



TUREGDI

About

The X Series is a new range of displacement crossover yachts designed by Leonardo Cecchi and developed with ArDeMo Yacht&Design team.

The models are presented in 3 different sizes 37, 45 and 55 mt and their design is developed around the same main characteristics; flexibility, comfort, luminosity, privacy.

There are classic layouts with guest cabins on LD, common areas on MD and upper decks with large outdoor lounge areas in all three models; bigger models has more privacy for the owner's areas infact part of the UD in the X450 and the complete upper deck in the X550 are dedicated expecially to the client.

Crew area is located in the LD at the extreme bow and is accompanied by large garages and technical storages, with the captain's cabin placed near the wheelhouse in each model.

The entire series has been designed around relax and flexibility always in contact with the sea; in fact, side windows and aft doors of upper decks can be fully opened to transform interior areas, both private and common, into terraces over the sea in order to emphasize the contact with nature and increase the internal brightness and comfort. By breaking down these glass barriers in all models, the dialogue between inside and outside has been increased, in the name of dynamism of life on board and design flexibility allowing each customer to change the interior layout according to his particular needs.



TUREGDI



TUREGDI







PROFILE

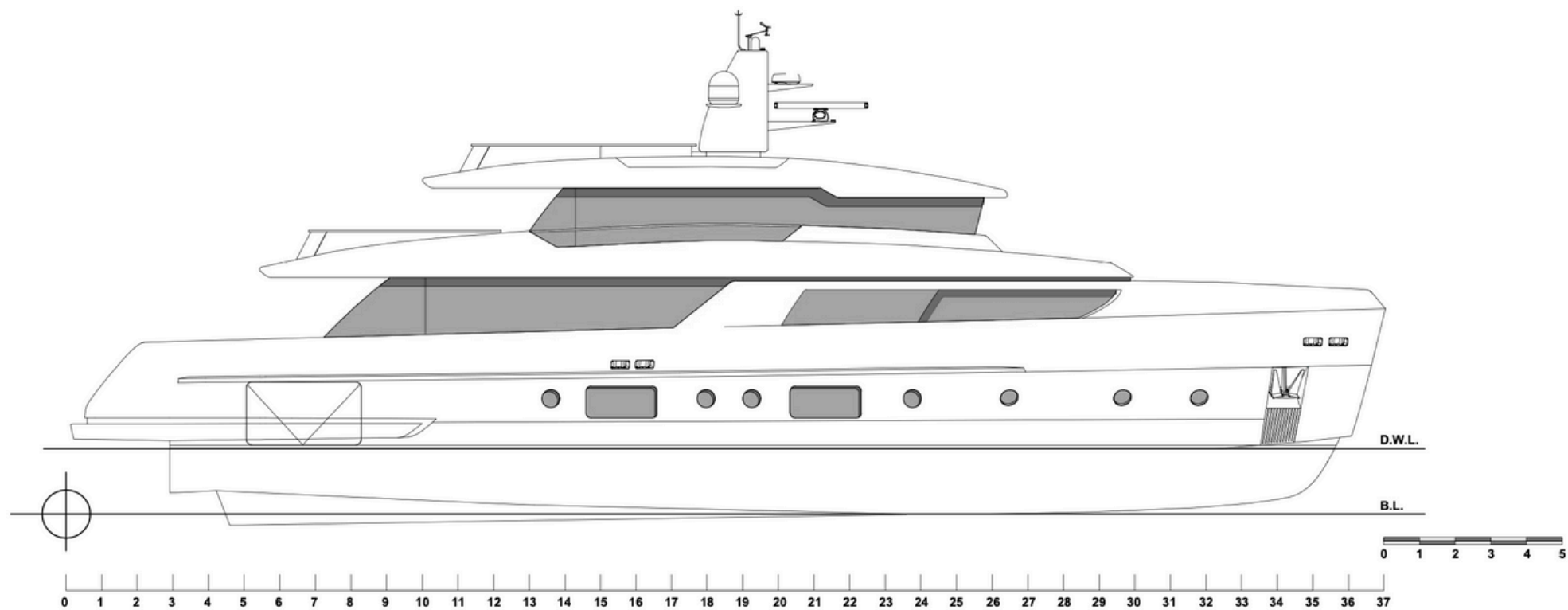

SUN DECK

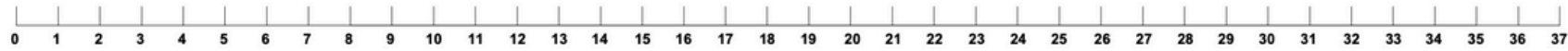
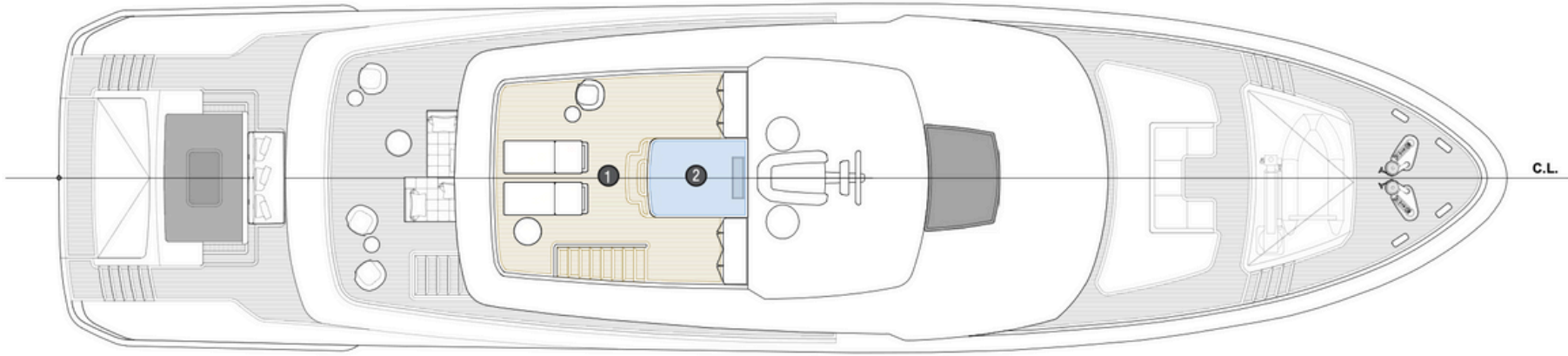

UPPER DECK

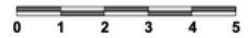
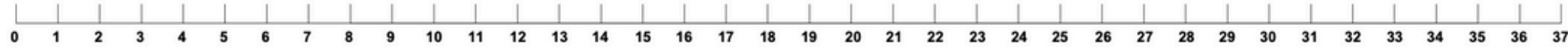
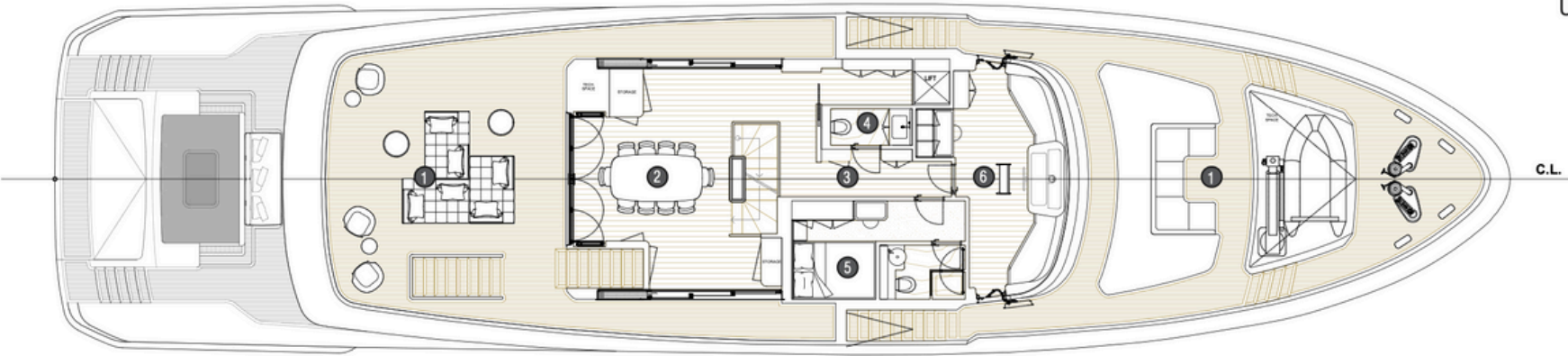

MAIN DECK

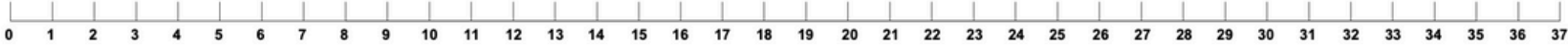
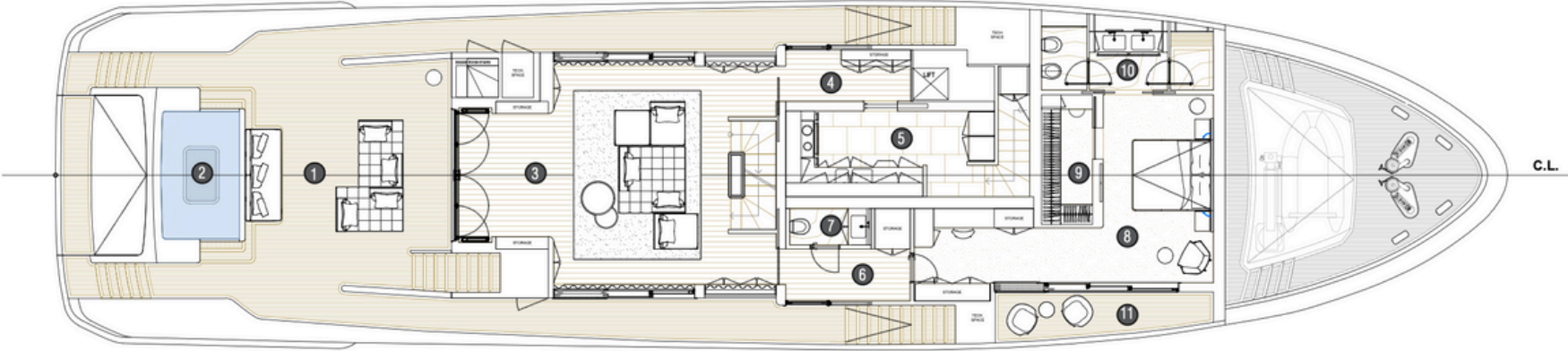

LOWER DECK

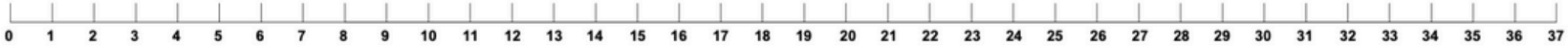
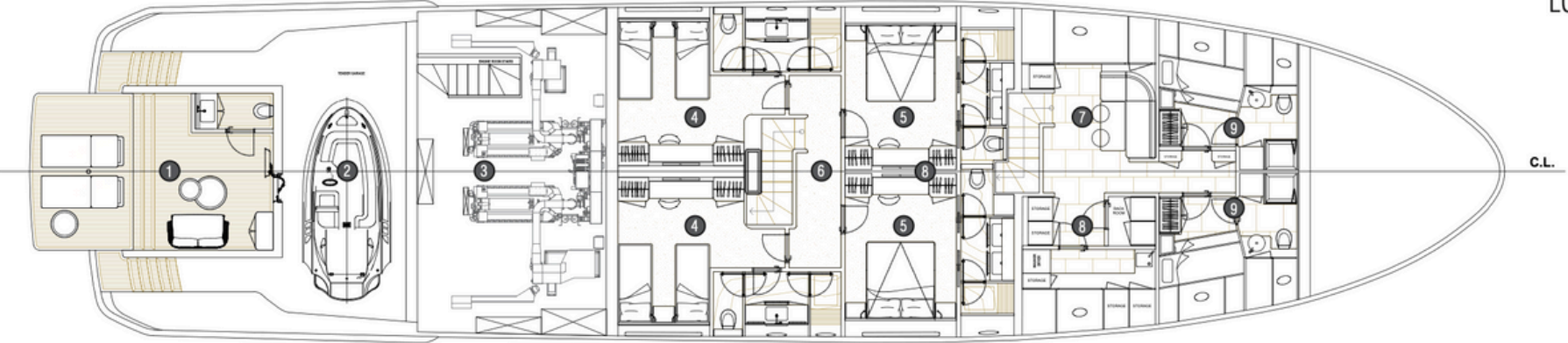

X SERIES



X370



X450



X550

All information in this brochure, including technical or performance data, images and drawings, are designer's exclusive property and should be considered as simple indications previously verified with some experts in the sector. These features, without contractual value, refer to the motoryacht model presented following specific technical and formal designer's decisions. This document is based on the information available at the time of its publication. Despite our best efforts to ensure the highest possible accuracy, the information contained here may not cover all details and any changes introduced after printing or could describe features not totally achievable.

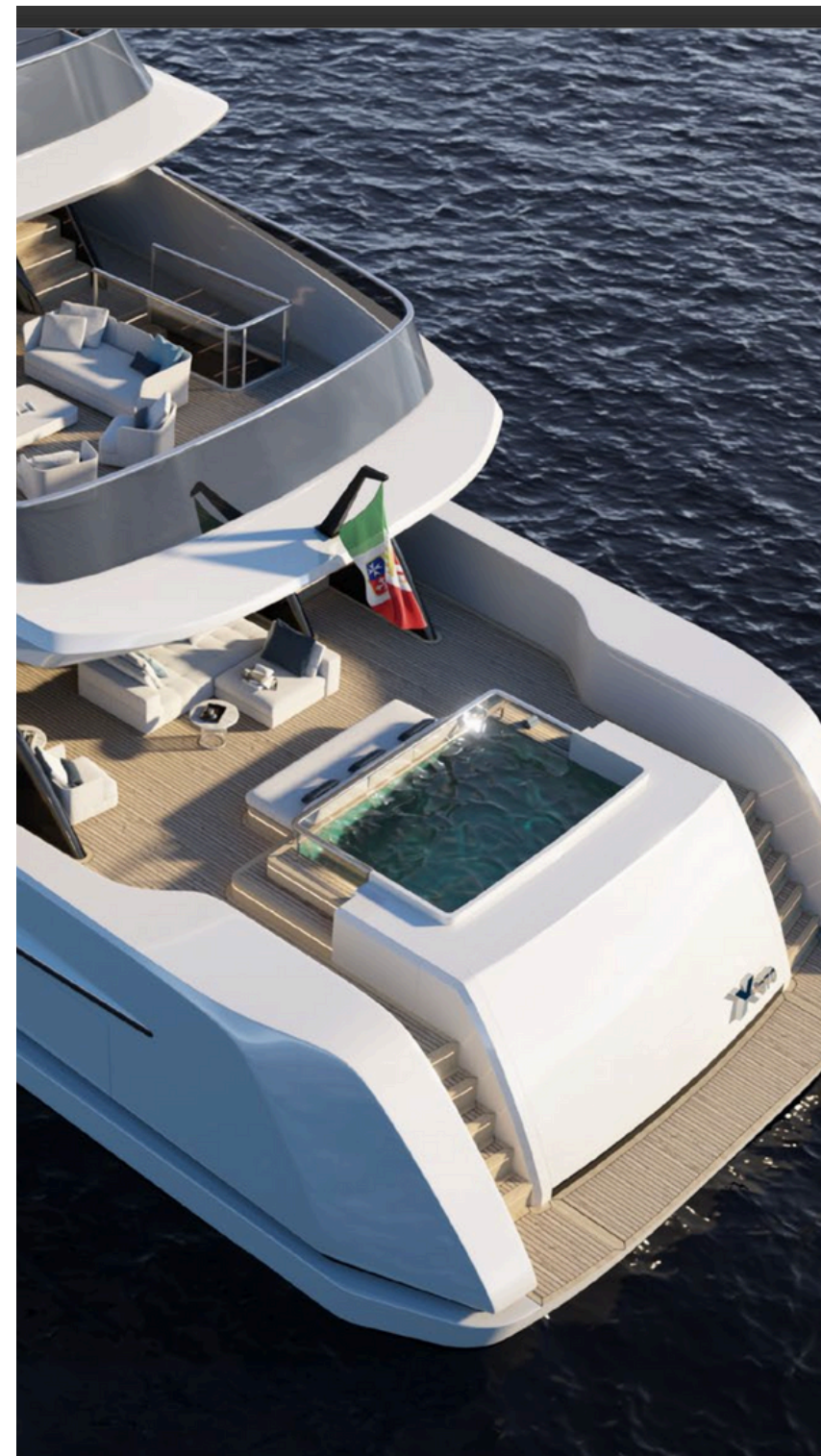

TUREDDI

UK Corporate Division

7-10 Chandos Street, Cavendish Square
W1G 9DQ London, United Kingdom
Phone: +44 (0)7553 291162
E-mail: sales@tureddigroup.com

Italian Production Site

Viale Ugo Foscolo 3 - 55049 Viareggio (LU) Italy
Via di Nugolaio snc, 56121 Pisa Italy
Phone: +39 050 6230314
E-mail: info@cntgroup.it